

## RULES FOR VISITORS TO THE SURROUNDINGS OF THE STATE CASTLE OF KUNĚTICKÁ HORA (THE "GROUNDS")

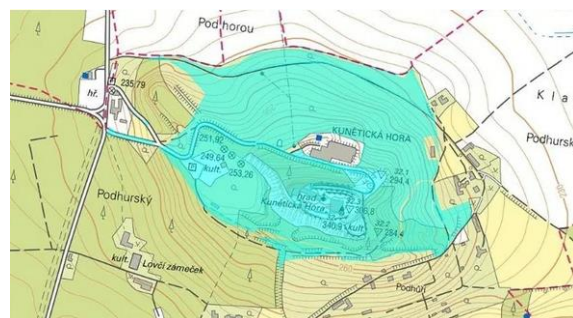

The grounds to which these Rules for Visitors apply are defined by the Land Registry, Folio No. 162 for the cadastral area 737194 Ráby (see the image above). It is an important cultural and natural heritage site, which is part of a national cultural heritage site, protected under Act No. 20/87 Coll. on State Heritage Protection, as amended. The grounds are a natural heritage site and part of the European NATURA 2000 network, the protection zones are regulated and defined by the applicable laws. By entering the grounds, the visitor agrees to respect these Rules for Visitors and to follow the instructions of the authorised staff of the heritage site management.

### Article 1 - ACCESS TO THE GOUNDS OF KUNĚTICKÁ HORA

The grounds are freely accessible. Visitors are on the grounds at their own risk. When on the grounds, visitors must pay close attention to uneven road surfaces, low passageways, or other hazards occasioned by the historic nature of the heritage site. The visitor must take the utmost care for their safety, the safety of their children and any other persons entrusted to them. In bad or windy weather and in winter, visitors must take extra care to avoid falling branches, snow and ice.

### Article 2 - OPENING HOURS

1. The grounds are open all year round.
2. Access to the grounds may be modified by the management of the heritage site if necessitated by the current operational or security situation. For operational reasons (ongoing work, event organisation, filming, commercial rental, etc.) the grounds or any part of it may be entirely closed to the public.

### Article 3 - ADMISSION FEE

1. There is no admission fee to the grounds. Exceptions are days when a cultural or social event is held on the grounds or any part of it, and entry to such an event is subject to an admission fee according to a price regulation issued.

### Article 4 - ORGANISATION OF VISITS

1. Touring the grounds is not organized. Exceptions are days when the grounds are used for other purposes - cultural events, rentals, maintenance, etc.
2. Visitors must follow the instructions of the staff of the heritage site management. If a visitor disobeys an instruction or order issued in the interest of the safety of visitors and the protection of the grounds, the visitor will be expelled from the grounds and must leave the grounds immediately. In addition, the visitor might be subjected to sanctions under the generally applicable laws.

### Article 5 - SAFETY AND PROTECTION

1. On the grounds, it is prohibited to:
  - a. Climb on rocks, climb on the torsos of the walls, enter the animal enclosures or fenced areas or areas marked with no-entry signs.
  - b. Use any narcotic or addictive substances. No persons reasonably suspected of being drunk or under the influence of drugs or other narcotic or addictive substances are allowed on the grounds.
  - c. Throw cigarette butts on the ground, light or use open fires.
  - d. Use any kinds of fireworks.
  - e. Carry weapons.
  - f. Move off the marked paths, tread new paths/trails, pick or break flowers, tear off blossoms/leaves of trees and bushes, break branches, climb trees and bushes, climb over and under fences, walls and railings, hunt animals and birds or in any way harm and damage or take away fauna and flora in the park.
  - g. Feed the animals kept in the park.
  - h. Climb down and disturb the dwellings of the animals kept there.
  - i. Damage, destroy or remove in any way the equipment of the park, or write or paint on walls, tiles and panelling, rocks and other natural and structural elements on the grounds.
  - j. Drive and park motor vehicles outside the designated areas (paved parking area), ride bicycles, scooters, roller skates, skateboards, etc. on the access roads and paths to the castle.
  - k. Post or hand out posters, leaflets, etc. without the knowledge of the heritage site management.
  - l. Throw rubbish outside the garbage cans or otherwise litter the grounds.
  - m. Camp, stay overnight or tent without prior permission from the heritage site management. Permissions can be requested at: [kunetickahora@npu.cz](mailto:kunetickahora@npu.cz)
  - n. Fly drones; any exceptions may be granted by the castle manager: [kunetickahora@npu.cz](mailto:kunetickahora@npu.cz)

- o. Pursue geocaching, place "caches" in the park area, any exceptions may be granted upon agreement with the castle manager: [kunetickahora@npu.cz](mailto:kunetickahora@npu.cz)
  - p. Disturb the peace, order, safety and good manners, play loud music or other sound recordings, shout and be loud, thereby disturbing other visitors and fauna.
  - q. Touch or tamper with the information system.
2. For the protection of the grounds and visitors, selected outdoor areas are monitored by a camera system with video recording. Information on the protection of personal data is available on the website at [www.npu.cz](http://www.npu.cz) in the personal data protection section.
  3. When visiting the grounds, visitors must pay close attention to uneven road surfaces, low passageways, water areas, or other hazards occasioned by the nature of the park. Visitors must take the utmost care for their safety, the safety of the children they are accompanying and any other persons entrusted to them.

### Article 6 - ACCESS TO THE GROUNDS WITH BICYCLES AND OTHER MEANS OF TRANSPORT

1. Visitors riding bicycles, scooters, roller skates, skateboards, etc. are not allowed to enter the grounds.

### Article 7 - ACCESS TO THE GROUNDS WITH ANIMALS

1. Animals are allowed in the park under the following conditions:
  - a. The animal must be on a leash.
  - b. The owner of the animal, or the person leading the animal, is responsible for the animal's behaviour, including any damage that might be caused by the animal to the property of the National Heritage Institute.
  - c. The person responsible for the animal must ensure that the animal's excrement is cleaned up.
  - d. The admission of the animal is free of charge.

### Article 8 - PLAY ELEMENTS ON THE GROUNDS

1. If there are any play elements on the grounds, the children's legal guardians/the person accompanying them to the grounds are responsible for their safety while using the play elements.

### Article 9 - TAKINGS PHOTOS AND MAKING VIDEOS

1. Visitors are allowed to take photos and videos for their own use while respecting and protecting the privacy of other visitors.
2. Taking photos and making videos by the visitors for public presentation and for commercial purposes must be agreed in advance in writing with the heritage site manager, specifying the date of taking the photos or making the videos and other details. Please send any requests for taking pictures/filming to: [kunetickahora@npu.cz](mailto:kunetickahora@npu.cz)
3. When there is a cultural or other event open to the public held on the grounds, the visitor acknowledges and understands that during the event, photographic/video documentation of the event may be taken. This documentation will be used exclusively to meet the legitimate interests of the National Heritage Institute (also referred to as "NHI") for the purposes of promoting the event, informing about the event, etc. on the website, social networks, printed materials, etc. The photographic/video documentation will be taken mainly to capture the course of the event as a whole, not specific individuals. If visitors have any objections to this, they can contact the event organiser. The National Heritage Institute always protects any personal data obtained against misuse and processes them in accordance with currently applicable laws. Information on the protection of personal data, including advice on the rights of visitors, is available on the NHI website at [www.npu.cz](http://www.npu.cz) in the personal data protection section.

### Article 10 - SPECIFIC PROVISIONS

1. Any events (cultural, social, sporting, etc.) held on the grounds must be authorized in writing in advance by the heritage site management. The organizer must follow the instructions and observe the obligations under their respective contract. In the case of non-compliance with this obligation, the management of the heritage site may cancel the event immediately and without refund.

### Article 11 - FINAL PROVISIONS

1. Visitors can submit their wishes, compliments or comments in writing directly at the heritage site in the book of wishes and complaints, which will be presented to them upon request by the head of the heritage site management. In addition, visitors may contact verbally, in writing or by telephone: [kunetickahora@npu.cz](mailto:kunetickahora@npu.cz); or the National Heritage Institute, Regional Heritage Site Management at Sychrov: [bidlasova.lucie@npu.cz](mailto:bidlasova.lucie@npu.cz)
2. The visitor is liable to the National Heritage Institute or the manager of the heritage site for violation of the Rules for Visitors and for damage to property, in accordance with the applicable laws. The liability of the management of the heritage site for any damage caused to visitors during their stay on the grounds is governed by the generally applicable laws. The National Heritage Institute is not liable to visitors for damages resulting from failure to comply with these Rules for Visitors.
3. Exceptions to the rules for visitors may be granted in justified cases by the manager of the heritage site.
4. These Rules for Visitors enter into effect on 1 October 2023 and the existing Rules for Visitors are being repealed at the same time.